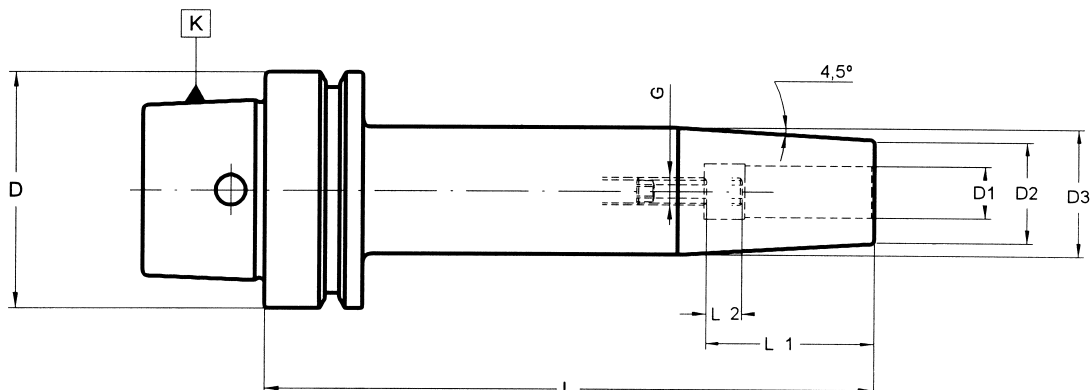
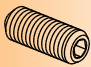

**012 18 12 .. ..****SHRINK FIT CHUCKS (LARGE LENGTH)**

DIN 69882-8

Maximum circular deviation between K & D<sub>1</sub> ≤ 0,003

D HSK-E	D <sub>1</sub>	D <sub>2</sub>	D <sub>3</sub>	L	L <sub>1</sub>	L <sub>2</sub>	G	COD.	€	
63	6	21	27	160	36	10	M-5	<b>012 18 12 34 06</b>		301 02 33 05 02
63	8	21	27	160	36	10	M-6	<b>012 18 12 34 08</b>		301 02 33 06 02
63	10	24	32	160	41	10	M-8	<b>012 18 12 34 10</b>		301 02 33 08 02
63	12	24	32	160	46	10	M-10	<b>012 18 12 34 12</b>		301 02 33 10 02
63	14	27	34	160	46	10	M-10	<b>012 18 12 34 14</b>		301 02 33 10 02
63	16	27	34	160	49	10	M-12	<b>012 18 12 34 16</b>		301 02 33 12 02

**Design:**

For Carbide, Cermet and HSS tool shanks according to DIN 6535 form HA and DIN 1835-1 form A  
**For tool shank tolerance of h4 for D > 6 mm. and h6 for D ≤ 6 mm.**

**Performance:**

Balanced according to ISO 1940-1 to **25.000 r.p.m. G 2.5** . Under request, able to balance up to 50.000 r.p.m.

**Delivery:**

With built-in bored through stop screw.