

001 14 33
35

SHELL END MILL ARBORS FOR CUTTERS WITH INTERNAL COOLING

For shell end mills with driving slot DIN 138

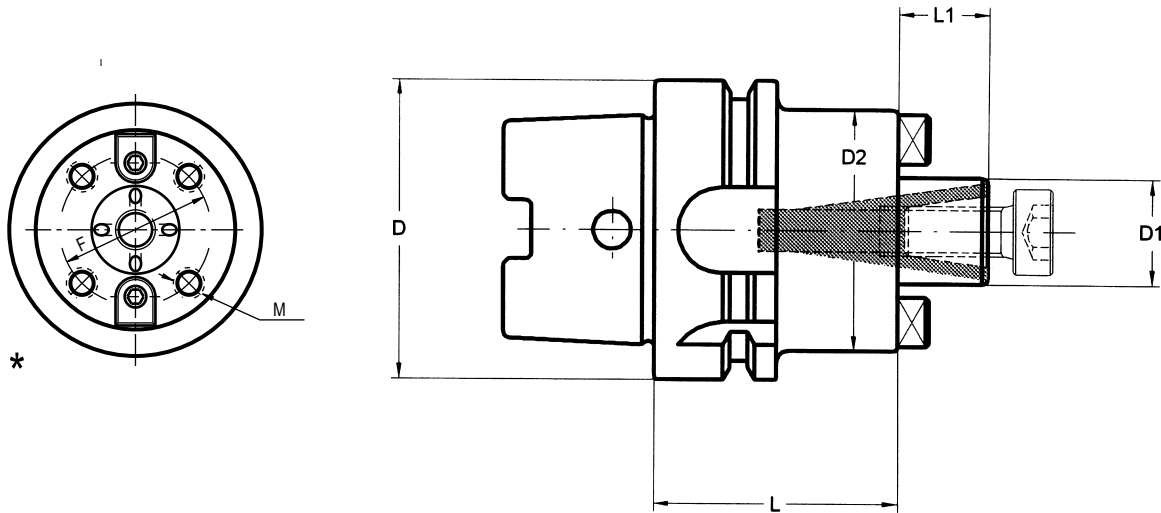

Runout between outer taper and $D_1 \leq 0,006$

D HSK-A	D ₁ h6	L	L ₁	M	D ₂	F	COD.	€
50	16	50	17	-	40	-	001 14 35 03 30	
50	22	60	19	-	50	-	001 14 35 03 40	
50	27	60	21	-	60	-	001 14 35 03 50	
63	16	50	17	-	40	-	001 14 35 04 30	
63	22	50	19	-	50	-	001 14 35 04 40	
63	27	60	21	-	60	-	001 14 35 04 50	
63	32	60	24	-	70	-	001 14 35 04 60	
*63	40	60	27	M-12	89	66,7	001 14 33 04 70	
80	22	50	19	-	50	-	001 14 35 05 40	
80	27	50	21	-	60	-	001 14 35 05 50	
80	32	60	24	-	70	-	001 14 35 05 60	
*80	40	60	27	M-12	89	66,7	001 14 33 05 70	
100	22	50	19	-	50	-	001 14 35 06 40	
100	27	50	21	-	60	-	001 14 35 06 50	
100	32	50	24	-	70	-	001 14 35 06 60	
*100	40	60	27	M-12	89	66,7	001 14 33 06 70	
*100	60	70	40	M-16	129	101,6	001 14 33 06 90	

* With additional 4 tapped holes for front clamping according to DIN 2079

Coolant tube to be ordered separately.

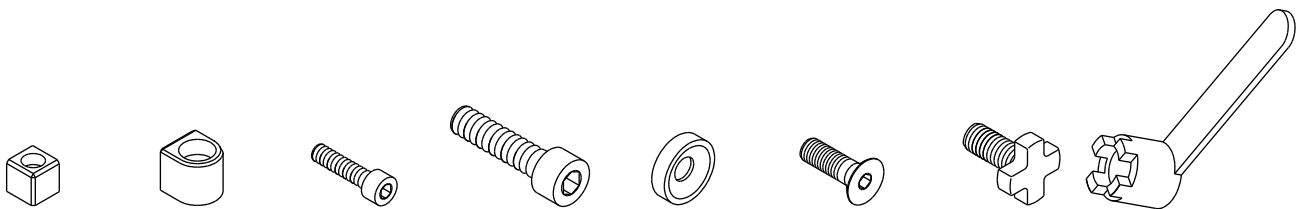

D ₁	OPTIONALS							
16	303 05 05 00 30	301 01 00 03 15	301 01 09 08 20			001 99 01 01 30	001 99 04 01 30	
22	303 05 05 00 40	301 01 01 04 12	301 01 09 10 25			001 99 01 01 40	001 99 04 01 40	
27	303 05 05 00 50	301 01 01 05 12	301 01 01 12 25			001 99 01 01 50	001 99 04 01 50	
32	303 05 05 00 60	301 01 01 05 16	301 01 01 16 30			001 99 01 01 60	001 99 01 01 60	
40	003 99 01 01 01	301 01 01 06 16		001 99 01 22 70	001 99 01 12 70	001 99 01 01 70	001 99 01 01 70	
60	303 05 04 00 02	301 01 01 12 25						