

## HSK-A hydraulic chucks with increased clamping force

Guhring no.										4299	
HSK-C d <sub>3</sub>	for clamping-Ø d <sub>1</sub> h6 mm	d <sub>2</sub> mm	d <sub>4</sub> mm	l <sub>1</sub> mm	l <sub>2</sub> mm	l <sub>5</sub> mm	incl. clamping screw 4900 ...	SW	kg	Code no.	Availability
80	6	26	50.0	70	37	24	6,014	5	1.50	6,080	●
80	8	28	50.0	70	37	24	8,014	5	1.50	8,080	●
80	10	30	50.0	80	41	35	10,014	5	1.50	10,080	●
80	12	32	50.0	85	46	40	12,014	5	1.60	12,080	●
80	14	34	50.0	85	46	40	12,014	5	1.60	14,080	●
80	16	38	50.0	95	49	51	16,014	5	1.70	16,080	●
80	18	40	50.0	95	49	51	16,014	5	1.80	18,080	●
80	20	42	50.0	95	51	52	20,114	5	1.80	20,080	●
80	25	57	63.0	110	57	65	20,114	6	2.60	25,080	●
80	32	64	75.0	125	61	63	20,114	6	3.20	32,080	●
100	6	26	50.0	75	37	26	6,014	5	2.40	6,100	●
100	8	28	50.0	75	37	26	8,014	5	2.40	8,100	●
100	10	30	50.0	90	41	42	10,014	5	2.50	10,100	●
100	12	32	50.0	95	46	47	12,014	5	2.50	12,100	●
100	14	34	50.0	95	46	47	12,014	5	2.50	14,100	●
100	16	38	50.0	100	49	53	16,014	5	2.70	16,100	●
100	18	40	50.0	100	49	53	16,014	5	2.70	18,100	●
100	20	42	50.0	105	51	59	20,114	5	3.20	20,100	●
100	25	57	63.0	110	57	62	20,114	6	3.30	25,100	●
100	32	64	75.0	110	61	62	20,114	6	3.80	32,100	●

## HSK-A hydraulic chucks

### Product information

- balancing quality: G6.3 / 15,000 rev./min
- MQL suitable
- axial length setting
- clamping-Ø for shank tolerance h6
- to DIN 69882-7
- also available in the overlength  
l<sub>1</sub> 150mm und 200 mm

### Scope of delivery

- incl. setting screw Guhring no. 4900
- incl. clamping key Guhring no. 4912
- for conventional cooling, order coolant delivery set, Guhring no. 4949 separately
- for MQL application, order as special tool holder with coolant delivery set, Guhring no. 4924 and setting screw, Guhring no. 4919

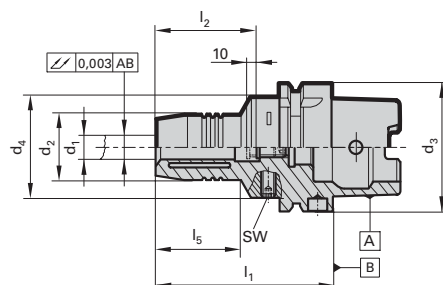

Guhring no.

4399



Guhring no.										4399	
HSK-A d <sub>3</sub>	for clamping-Ø d <sub>1</sub> h6 mm	d <sub>2</sub> mm	d <sub>4</sub> mm	l <sub>1</sub> mm	l <sub>2</sub> mm	l <sub>5</sub> mm	incl. setting screw 4900 ...	SW	kg	Code no.	Availability
32	6	26	40.0	80	37	29	6,014	4	0.44	6,032	○
32	8	28	40.0	80	37	29	8,014	4	0.40	8,032	○
32	10	30	40.0	85	41	35	8,014	4	0.40	10,032	○
32	12	32	40.0	90	46	40	8,014	4	0.40	12,032	○

# HSK-A hydraulic chucks

HSK-C d <sub>3</sub>	for clamping-Ø d <sub>1</sub> h6 mm	d <sub>2</sub> mm	d <sub>4</sub> mm	l <sub>1</sub> mm	l <sub>2</sub> mm	l <sub>5</sub> mm	incl. setting screw 4900 ...	Guhring no.		4399	
								SW	kg	Code no.	Availability
40	6	26	33.5	70	37	36	6,014	4	0.60	6,040	○
40	8	28	33.5	70	37	36	8,014	4	0.60	8,040	○
40	10	30	33.5	75	41	42	8,014	4	0.60	10,040	○
40	12	32	33.5	80	46	48	8,014	4	0.60	12,040	○
50	6	26	40.0	70	37	28	6,014	4	0.80	6,050	○
50	8	28	40.0	70	37	28	8,014	4	0.80	8,050	○
50	10	30	40.0	75	41	34	10,014	4	0.80	10,050	○
50	12	32	40.0	85	46	44	12,014	4	0.80	12,050	○
50	14	34	40.0	85	46	44	12,014	5	0.80	14,050	○
50	16	38	53.0	90	49	30	16,014	5	1.10	16,050	○
50	18	40	57.0	90	49	30	16,014	5	1.10	18,050	○
50	20	42	60.0	90	51	29	20,014	5	1.10	20,050	○
63	6	26	50.0	70	37	24	6,014	5	1.10	6,063	○
63	8	28	50.0	70	37	24	8,014	5	1.10	8,063	○
63	10	30	50.0	80	41	35	10,014	5	1.10	10,063	○
63	12	32	50.0	85	46	40	12,014	5	1.10	12,063	○
63	14	34	50.0	85	46	40	12,014	5	1.20	14,063	○
63	16	38	50.0	90	49	46	16,014	5	1.30	16,063	○
63	18	40	50.0	90	49	47	16,014	5	1.30	18,063	○
63	20	42	50.0	90	51	48	20,014	5	1.30	20,063	○
63	25	57	63.0	120	57	59	20,014	6	2.30	25,063	○
63	32	64	75.0	125	61	63	20,014	6	2.90	32,063	○
63	6	26	50.0	150	37	103	6,014	5	1.50	6,163	○
63	8	28	50.0	150	37	104	8,014	5	1.50	8,163	○
63	10	30	50.0	150	41	104	10,014	5	1.50	10,163	○
63	12	32	50.0	150	46	105	12,014	5	1.50	12,163	○
63	14	34	50.0	150	46	105	12,014	5	1.70	14,163	○
63	16	38	50.0	150	49	106	16,014	5	1.80	16,163	○
63	18	40	50.0	150	49	107	16,014	5	1.90	18,163	○
63	20	42	50.0	150	51	108	20,014	5	1.90	20,163	○
63	6	26	50.0	200	37	153	6,014	5	1.70	6,263	○
63	8	28	50.0	200	37	154	8,014	5	1.70	8,263	○
63	10	30	50.0	200	41	154	10,014	5	1.80	10,263	○
63	12	32	50.0	200	46	155	12,014	5	1.80	12,263	○
63	14	34	50.0	200	46	155	12,014	5	2.00	14,263	○
63	16	38	50.0	200	49	156	16,014	5	2.20	16,263	○
63	18	40	50.0	200	49	157	16,014	5	2.30	18,263	○
63	20	42	50.0	200	51	158	20,014	5	2.50	20,263	○
80	6	26	50.0	70	37	24	6,014	5	1.50	6,080	○
80	8	28	50.0	70	37	24	8,014	5	1.50	8,080	○
80	10	30	50.0	80	41	35	10,014	5	1.50	10,080	○
80	12	32	50.0	85	46	40	12,014	5	1.60	12,080	○
80	14	34	50.0	85	46	40	12,014	5	1.60	14,080	○
80	16	38	50.0	95	49	51	16,014	5	1.70	16,080	○
80	18	40	50.0	95	49	51	16,014	5	1.80	18,080	○
80	20	42	50.0	95	51	52	20,014	5	1.80	20,080	○
80	25	57	63.0	110	57	65	20,014	6	2.60	25,080	○
80	32	64	75.0	125	61	63	20,014	6	3.20	32,080	○
100	6	26	50.0	75	37	26	6,014	5	2.40	6,100	○
100	8	28	50.0	75	37	26	8,014	5	2.40	8,100	○
100	10	30	50.0	90	41	42	10,014	5	2.50	10,100	○
100	12	32	50.0	95	46	47	12,014	5	2.50	12,100	○
100	14	34	50.0	95	46	47	12,014	5	2.50	14,100	○
100	16	38	50.0	100	49	53	16,014	5	2.70	16,100	○
100	18	40	50.0	100	49	53	16,014	5	2.70	18,100	○
100	20	42	50.0	105	51	59	20,014	5	3.20	20,100	○
100	25	57	63.0	110	57	62	20,014	6	3.30	25,100	○
100	32	64	75.0	110	61	62	20,014	6	3.80	32,100	○

Hydraulic chucks