

HSK-A hydraulic chucks with radial length setting

Product information

- balancing quality: G6.3 / 15,000 rev./min
- robust, radially operated length setting
- clamping-Ø for shank tolerance h6

Scope of delivery

- incl. clamping key Art.-Nr. 4912
- incl. hexagon key inserts for radial length setting
- order coolant delivery set, Guhring no. 4949 separately

Guhring no.

4396

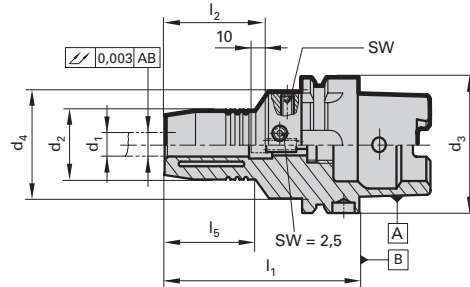

HSK-A d ₃	for clamping-Ø d ₁ h6 mm	d ₂ mm	d ₄ mm	l ₁ mm	l ₂ mm	l ₅ mm	SW	kg	Code no.	Availability
50	6	26	40	80	37.0	35.0	4	0.80	6,050	○
50	8	28	40	80	37.0	36.0	4	0.80	8,050	○
50	10	30	40	85	41.0	38.0	4	0.90	10,050	○
50	12	32	40	90	46.0	40.0	4	0.90	12,050	○
50	14	34	40	90	46.0	46.0	5	0.90	14,050	○
50	16	38	53	95	49.0	36.5	5	1.20	16,050	○
50	18	40	57	95	49.0	36.5	5	1.20	18,050	○
50	20	42	60	100	51.0	39.0	5	1.30	20,050	○
63	6	26	50	80	37.0	33.0	5	1.10	6,063	○
63	8	28	50	80	37.0	33.0	5	1.10	8,063	○
63	10	30	50	85	41.0	38.0	5	1.10	10,063	○
63	12	32	50	90	46.0	40.0	5	1.20	12,063	○
63	14	34	50	90	46.0	46.0	5	1.20	14,063	○
63	16	38	50	95	49.0	51.0	5	1.30	16,063	○
63	18	40	50	95	49.0	52.0	5	1.30	18,063	○
63	20	42	50	100	51.0	51.0	5	1.40	20,063	○
63	25	57	63	120	57.0	54.5	6	2.30	25,063	○
63	32	64	75	125	61.0	57.5	6	2.70	32,063	○
80	6	26	50	85	37.2	35.5	5	1.50	6,080	○
80	8	28	50	85	37.2	36.0	5	1.50	8,080	○
80	10	30	50	90	41.0	38.0	5	1.50	10,080	○
80	12	32	50	95	46.0	40.0	5	1.60	12,080	○
80	14	34	50	95	46.0	41.0	5	1.60	14,080	○
80	16	38	50	100	49.0	46.0	5	1.60	16,080	○
80	18	40	50	100	49.0	46.0	5	1.80	18,080	○
80	20	42	50	105	51.0	51.0	5	1.80	20,080	○
80	25	57	63	115	57.0	58.5	6	2.60	25,080	○
80	32	64	75	125	61.0	58.5	6	3.20	32,080	○
100	6	26	63	85	37.0	33.0	5	2.50	6,100	○
100	8	28	63	85	37.0	33.0	5	2.70	8,100	○
100	10	30	63	90	41.0	36.0	5	2.80	10,100	○
100	12	32	63	95	46.0	40.0	5	2.80	12,100	○
100	14	34	63	95	46.0	41.0	5	2.70	14,100	○
100	16	38	63	100	49.0	46.0	5	2.90	16,100	○
100	18	40	63	100	49.0	46.0	5	2.80	18,100	○
100	20	42	75	105	51.0	51.0	5	3.20	20,100	○
100	25	57	75	115	57.3	55.5	6	3.90	25,100	○
100	32	64	75	120	61.0	63.5	6	4.10	32,100	○

Hydraulic chucks